

Blanks and Toolholders for Forming Grooving

palbit[®]
TOOLING SOLUTIONS EXPERTS
SINCE 1916

PalbitUSA.com

PILOT
Precision Products

FORMING
Grooving

SINCE 1916

FORMING GROOVING

BLANKS

FG	I	13
1	2	3

1 - Product Line

FG - Forming Grooving

2 - Product Type

I - Insert

3 - Edge Width (W)

13 - 13mm

16 - 16mm

20 - 20mm

32 - 32mm



TOOLHOLDERS



1 - Product Line

FG - Forming Grooving

2 - Cutting Width

H - Holder

3 - Edge Width (Forming)

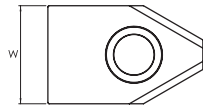

13 - 13 mm

16 - 16 mm

20 - 20 mm

32 - 32 mm (2 holes)

4 - Toolholder Type (Forming)

Type A



Type B



Type C



Type C

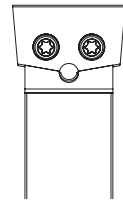

5 - Toolholder Total Length

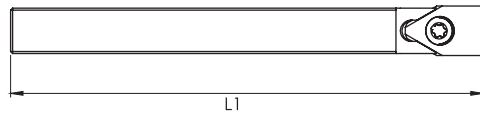

125 - 125 mm

150 - 150 mm

6 - Toolholder Depth

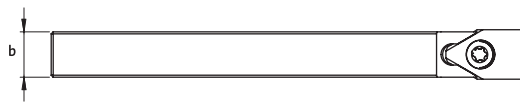

10 - 10 mm

12 - 12 mm

14 - 14 mm

16 - 16 mm

20 - 20 mm

7 - Insert Height



10 - 10 mm

12 - 12 mm

14 - 14 mm

16 - 16 mm

25 - 25 mm

8 - Insert Relief Angle



0°

5°

FORMING GROOVING

BLANKS & TOOLHOLDERS

FGI

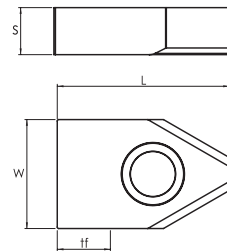
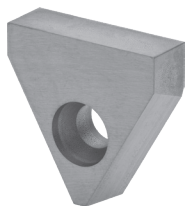

(1) Geometry Code	(2) Grade Code	UNC PH0930	Dimensions			
			W	S	L	tf
1130550	BLANK FGI 13	☉	13	5.35	20.70	6.00
1130551	BLANK FGI 16	☉	16	5.35	25.00	10.00
1130552	BLANK FGI 20	☉	20	6.35	20.70	7.00
1130615	BLANK FGI 20 L	☉	20	6.35	25.00	11.00

☉ Stock item

○ Available Upon Request

Insert Order Code = (1) Geometry Code + (2) Grade Code

Type A

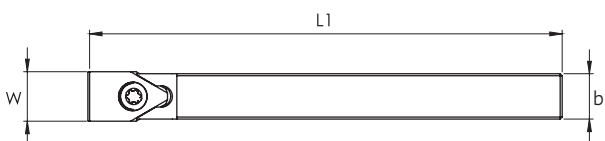

Type B

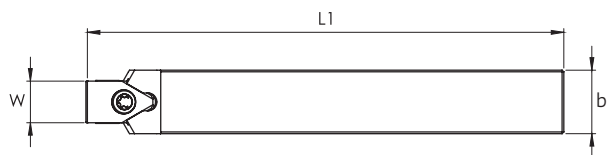

Type C



Type A|B|C



Order Code		ISO Reference	Dimensions					Insert	Toolholder Type	Stock	
a* 0°	a* 5°		h	h1	b	L1	W			0°	5°
113056500	113055400	FGH 13-A 125 12.12 - 0°/5°	12	12	12	125	13	FGI 13	A	☉	☉
113056600	113055500	FGH 13-B 125 14.14 - 0°/5°	14	14	14	125	13	FGI 13	B	☉	☉
113058000	113058100	FGH 13-B 125 16.16-0°/5°	16	16	16	125	13	FGI 13	B	○	☉
113056700	113055600	FGH 13-C 125 10.10 - 0°/5°	10	10	10	125	13	FGI 13	C	○	☉
113056800	113055700	FGH 16-A 125 16.16 - 0°/5°	16	16	16	125	16	FGI 16	A	☉	☉
113056900	113055800	FGH 16-B 150 20.20 - 0°/5°	20	20	20	150	16	FGI 16	B	☉	☉
113057000	113055900	FGH 16-C 125 14.14 - 0°/5°	14	14	14	125	16	FGI 16	C	☉	☉
113057100	113056000	FGH 20-A 150 20.20 - 0°/5°	20	20	20	150	20	FGI 20	A	○	☉
113057200	113056100	FGH 20-C 125 16.16 - 0°/5°	16	16	16	125	20	FGI 20	C	○	☉
113061600	113061700	FGH 20L-A 150 20.20-0°/5°	20	20	20	150	20	FGI 20 L	A	☉	☉
113061800	113061900	FGH 20L-C 125 16.16-0°/5°	16	16	16	125	20	FGI 20 L	C	☉	☉

☉ Stock item

○ Available Upon Request

FORMING GROOVING

BLANKS & TOOLHOLDERS

FGI

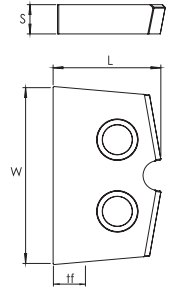
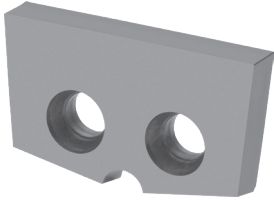

(1) Geometry Code	(2) Grade Code	UNC	Dimensions (mm)			
			W	S	L	tf
1130553	BLANK FGI 32	PH0930	32	5.00	19.80	7.00

Stock item

Available Upon Request

Insert Order Code = (1) Geometry Code + (2) Grade Code

Type C

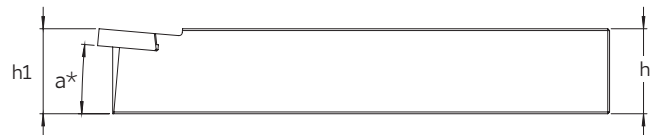
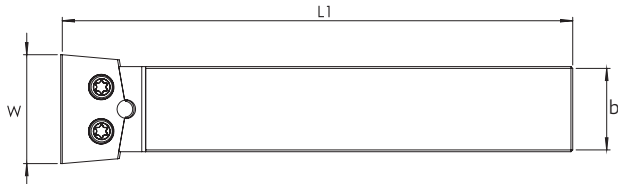

Order Code		ISO Reference	Dimensions (mm)					Insert	Toolholder Type	Stock	
a* 0°	a* 5°		h	h1	b	L1	W			0°	5°
113057300	113056200	FGH 32-C 150 25.25 - 0°/5°	25	25	25	150	32	FGI 32	C	<input type="checkbox"/>	<input checked="" type="checkbox"/>

Stock item

Available Upon Request



PalbitUSA.com



FORMING
Grooving

U.S. Partner:



Precision Products

15 Merrigan Way | South Deerfield, MA 01373

413-350-5200 | PilotPrecision.com

ISO 9001:2015



SINCE 1916